

Alexander McNichie and Charles Sullivan.

Line Between Donation and Depreciation Lands.

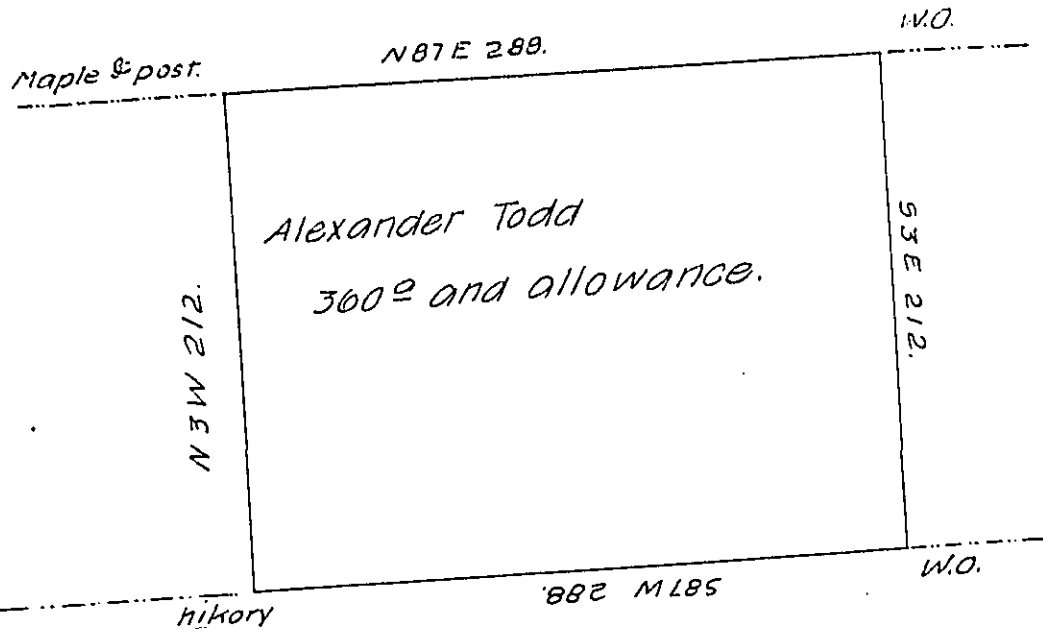

John Ohara.

Lewis Wilson

A draught of a tract of Land Situate on the Waters Connocaness-  
ing Creek in Butler County Containing three Hundred Sixty Acres and  
 Allowance of Six per Cent. for Roads &c. surveyed on the 20<sup>th</sup> day <sup>of May,</sup> 1808 by  
 Virtue of a Warrant Granted to Alexander Todd dated April 14<sup>th</sup> 1794.  
 for 400 Acres.

Ja<sup>s</sup> Irvine, D.S.

To Samuel Cochran, Esq<sup>r</sup>, S.G.

IN TESTIMONY that the above is a copy of the original remaining on file in  
 the Department of Internal Affairs of Pennsylvania, made  
 conformably to an Act of Assembly approved the 16th day of  
 February, 1833, I have hereunto set my Hand and caused  
 the Seal of said Department to be affixed at Harrisburg,  
 this seventeenth day of October, 1906

*Edward P. ...*  
 Secretary of Internal Affairs.